

# PURELL® Waterless Surgical Scrub

**DIRECTIONS FOR USE:** Can be used for first scrub of the day and on going throughout the day.

## Are my hands clean?

If soiled or dirty, wash with non-medicated soap prior to surgical preparation.

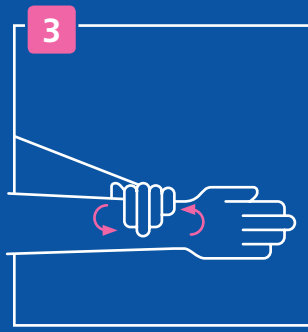
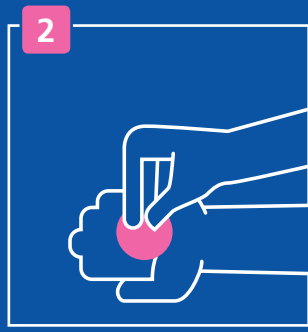
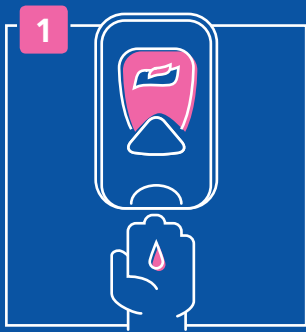

### APPLICATION 1

On dry hands, **dispense 2 doses** (plus as needed) into the palm of the left hand.

Dip fingertips of right hand into the product and work under nails.

Spread product evenly in a circular motion of the right hand and forearm, up to the elbow.

### APPLICATION 2

Repeat steps 1-3 for the opposite hand and arm.

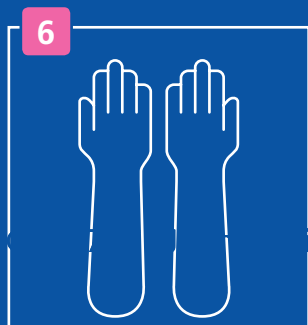
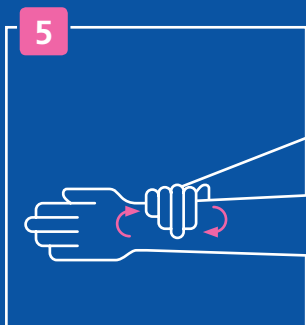

### APPLICATION 3

**Dispense 2 doses.** Cover hands up to wrists. Rub back of hands, wrists, fingers, thumbs and palms.

**Allow hands and arms to completely air dry before donning gloves.** Hold hands above elbow height during this process.

Ensure sufficient product is used to keep hands and arms wet and rubbed for

**120 seconds**